

INSTALLATION INSTRUCTIONS

DESCRIPTION: Cargo Box Kit
PART NUMBER: BG4-F83P0-V0
MODEL: '18~ Wolverine X4



⚠ WARNING

Please read and understand these instructions completely before installation to avoid possible injury, or damage to the accessory or vehicle.

NOTICE:

Installation of this kit requires a torque wrench and should be performed by an authorized Yamaha dealer or a qualified mechanic.

Always secure the Cargo Box to the bed with the clamping knobs and close and secure the box lid with the rubber straps before driving the vehicle.

WARRANTY INFORMATION:

See your Yamaha dealer for a copy of the warranty statement.

DEALER OR INSTALLER:

These instructions contain important information for future reference and *must* be given to the customer.

PARTS LIST:

No.	Part Number	Description	Qty
--	BG4-F83P0-V0	Cargo Box Kit	--
①	*	Cargo Box	1
②	*	Knurled Knob	4
③	*	M6x18mm Flange Bolt	1
④	*	Anti-Seize Grease	1

* Part supplied with kit only and not available separately.

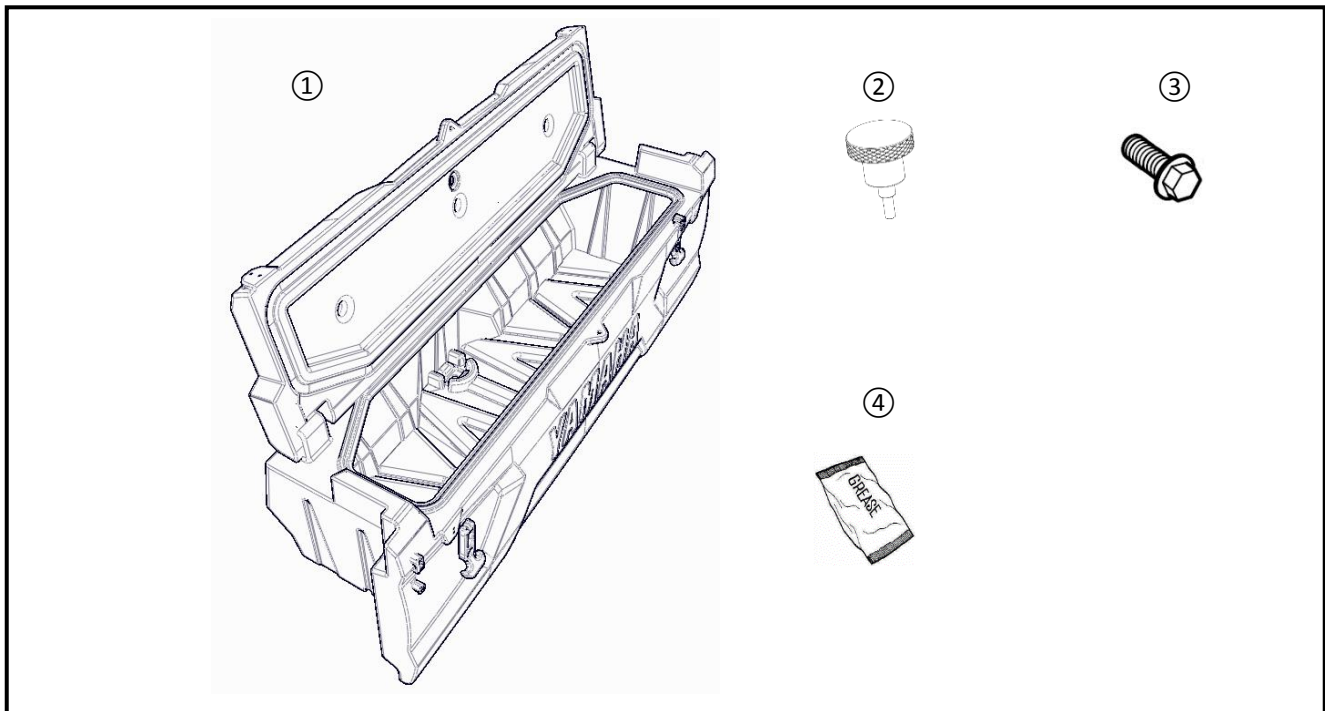

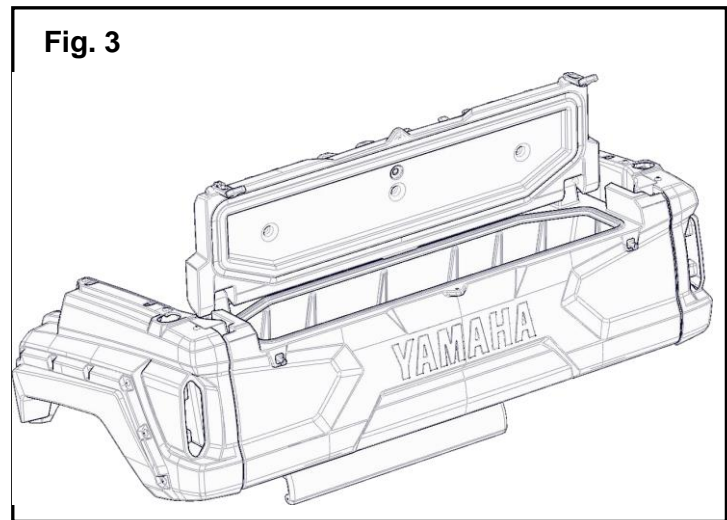
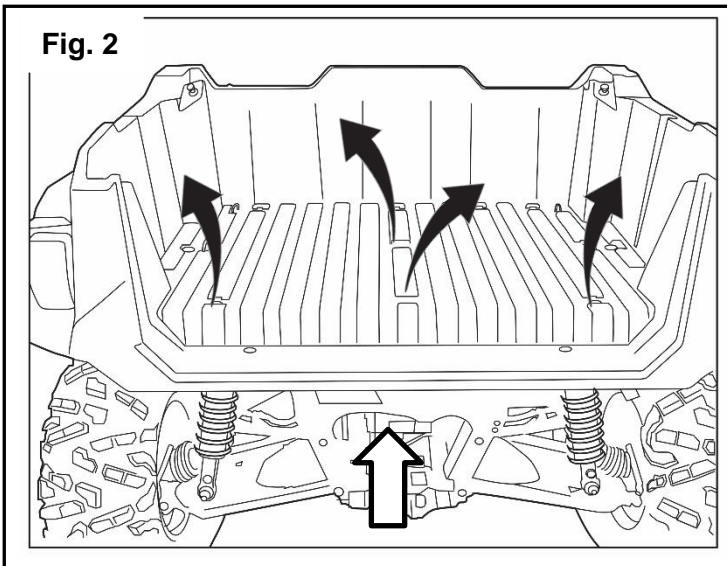
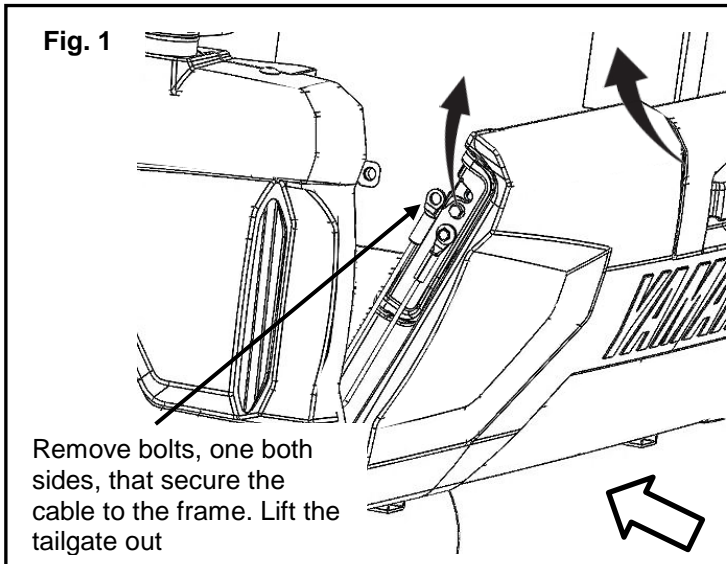

PREPARATION:

- Place the vehicle on a secure and level surface. Set the parking brake.
- Clean the mount surfaces before beginning installation.

INSTALLATION:

1. Working from the rear of the vehicle bed, remove the stock tailgate. There is a cable on each side. Remove the bolt that secures the cable to the frame on each side. See Fig. 1. Then, rotate tailgate and lift it off the vehicle. Reinstall tailgate cable bolts into the frame and torque to 5-8 Nm. The tailgate is not reused for this installation.
2. Remove 4 stock button head bolts from the bed, in the locations shown in Fig. 2.
3. Apply a dab of anti-seize grease to the threads on the ③M6x18mm bolt and thread the bolt in and out of each of the 4 stock holes shown in Fig. 4. Discard bolt.

Warning: This is done to chase and clean the threads in the frame. Avoid cross threading the bolt. Add grease as needed. Ensure the bolt is perpendicular to the bed when you begin to engage the threads in the 4 holes. If excessive resistance is encountered, immediately back off bolt and try again.

4. Install the rear storage box ① by positioning it in the bed over the 4 mount holes (shown in Fig. 3).
5. Open the rear storage box lid, apply a dab of anti-seize grease to each ② clamping knobs and screw them into the 4 threaded holes in the bed. Turn clockwise by hand to tighten securely as shown in Fig. 4 and 5.
6. Use the rubber straps on the lid of the rear storage box to hold the box closed during vehicle operation. A padlock can be used to lock the lid if desired.

NOTICE:

If the Crossover Rear Storage Box is being removed temporarily, also remove and store the flange washers from the bed to prevent them from being lost.

Fig. 4

Be sure to thread the ③ M6 bolt into these 4 holes to clean up the threads.

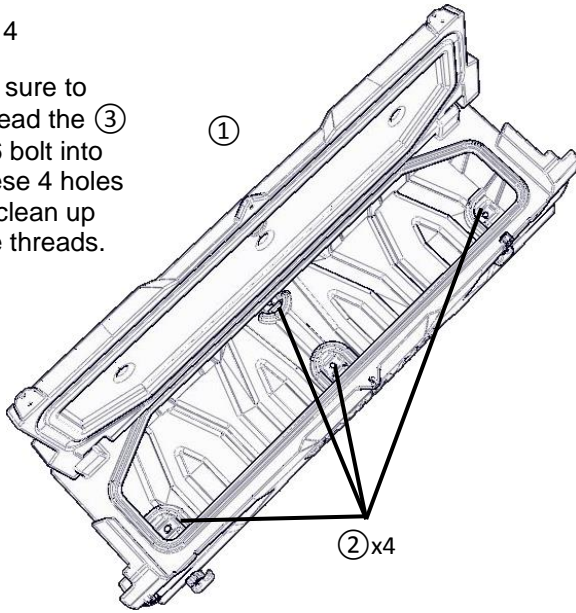

MAINTENANCE:

Periodically, check torque on all hardware. If loose hardware is found, re-torque to specification.

CARE AND CLEANING:

Clean painted metal parts with a clean soft cloth and mild soap and water solution. Rinse and dry.

CUSTOMER SERVICE:

For further information see your Yamaha dealer.

ESTIMATED TIME TO INSTALL: 0.5 HRS.

Fig. 5

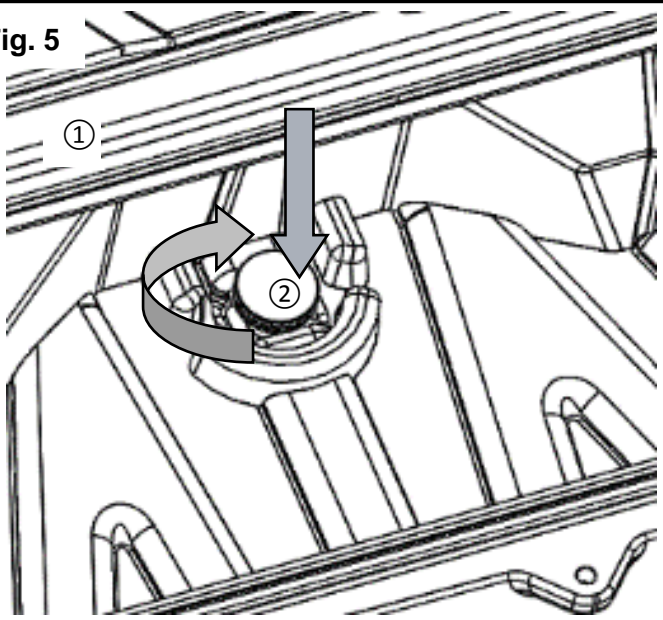

Fig. 6

